

Flush hinge Series 7900

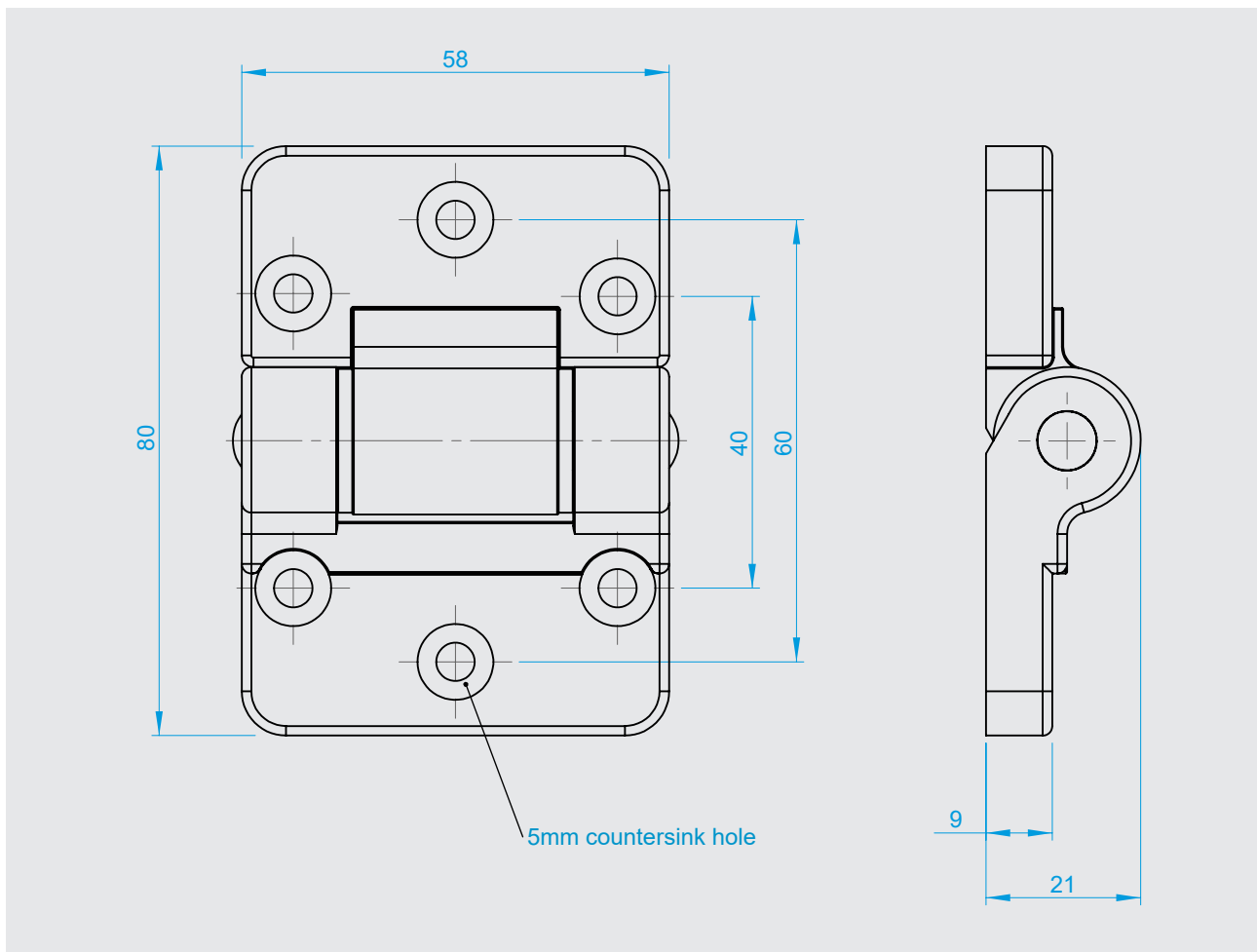

- For flush doors
- For refrigerated cabinets, counter construction and so on
- Can be used either horizontally or vertically
- Support capacity with 2 hinges approx. 25 kg



Hinge

Chrome-plated	7900-020016
white aluminum (RAL 9006)	7900-020015

This hinge for flush applications was initially developed for chests. But it has a lot more going for it: It is now used in all kinds of areas where flush opening solutions are required - such as refrigerated cabinets or counters. It can be used either horizontally or vertically on either side and holds up to 25 kg in position in a double pack.

Materials

Hinge body:	Die-cast zinc, chrome-plated
Hinge pin:	Steel, zinc-plated
Sliding bushing:	Plastic
Finish:	Chrome-plated, powder-coated
Standard colors:	Chrome, white aluminum (RAL 9006) Other colors (RAL) on request

Note: Please also see the assembly instructions.

